

承认书
Specification

客户名称:

Customer Name: _____
(请填写贵司全名)

规格书编号:

Spicification NO : _____ **Spec-CMBF-H Series Rev.01** _____

客户品名 :

Product P/N : _____
(请填写贵司物料品名)

华拓品名 :

Manufacturer's P/N : _____
(请填写欲承认的华拓品名)

变更履历:

Revised record:

Rev.	Date	Changed Contents	Change reasons	Approved by
01	2013-12-10	New released		Buck

客户承认栏 (请签名并写明日期后回传)

广州华拓电子科技有限公司

Customer's Approval

Confirmed	Checked	Prepared
Buck	Dana	Amy

Type:CMBF1608H,2012H,3216H

Feature/特长

- Monolithic inorganic material construction.
- Excellent solderability and heat resistance.
- High current,low DCR
- Used in a wide range of frequency to suppress EMI
- RoHS compliant.
- 无机材料构造。
- 良好的可焊性、耐焊性。
- 大电流、低DCR。
- 能在较宽的频率范围内抑制EMI。
- RoHS指定对应。

Application/用途

For noise suppression applications such as mobile phones, Personal computers,communication equipment,PDA's,Printers and other computer peripheral products.

适用于移动电话、电脑及通信設備、PDA、打印机及周边设备噪音抑制用。

Dimensions/外形图

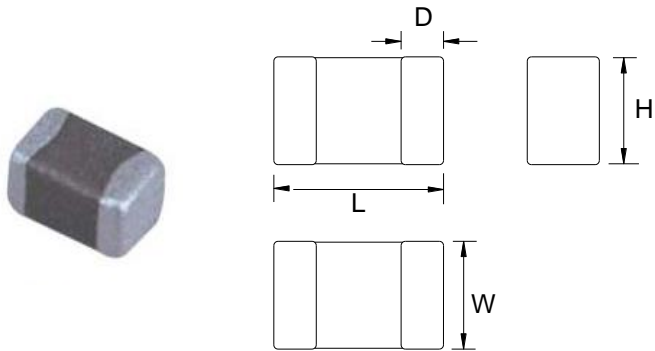

Recommended Land Pattern

推荐贴装尺寸

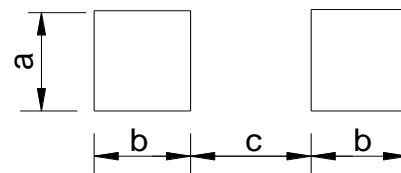

Unit: mm

Type	L	W	H	D	a	b	c	Packaging (pcs/reel)
CMBF1608H	1.6± 0.15	0.8± 0.15	0.8± 0.15	0.3± 0.2	0.8	1.0	0.6	4000
CMBF2012H	2.0± 0.2	1.25± 0.2	0.85± 0.2	0.5± 0.3	1.0	1.0	1.0	4000
CMBF3216H	3.2± 0.2	1.6± 0.2	1.1± 0.2	0.5± 0.3	1.4	1.1	2.2	3000

Dimensions without tolerance are typical./无公差尺寸为参考值。

Product Identification/品名注释

C M B F 1608 H - 300 P C K
(1) (2) (3) (4) (5) (6) (7) (8) (9) (10)

(1) SMD/表面安装制品

(2) Multilayer chip /叠层片式

(3) Beads/磁珠

(4) Ferrite/铁氧体

(5) Dimension symbol/尺寸表示:

1608= 1.6 X 0.8 mm (L X W)

(6) Application Code:High Current type for power

用途编码:电源用大电流型号

(7) Impedance value/阻抗值:

300= 30Ω,301=300Ω,102=1000Ω

(8) Tolerance/公差: P (±25%),M (±20%)

(9) Packing Style/包装形态:C=Carrier taping/载带包装

(10) Characteristic identification/特性标识

CMBF1608H Electrical Characteristics

Part Number	Impedance (Ω) ①	Test Frequency (MHz)	Rated current max. (mA)	DCR max. (Ω)
CMBF1608H-110PCK	11 ± 25%	100	2000	0.10
CMBF1608H-300PCK	30 ± 25%	100	5000	0.02
CMBF1608H-470PCK	47 ± 25%	100	3000	0.04
CMBF1608H-500PCK	50 ± 25%	100	3000	0.04
CMBF1608H-600PCK	60 ± 25%	100	3000	0.04
CMBF1608H-800PCK	80 ± 25%	100	3000	0.04
CMBF1608H-101PCK	100 ± 25%	100	3000	0.04
CMBF1608H-121PCK	120 ± 25%	100	2500	0.05
CMBF1608H-151PCK	150 ± 25%	100	2000	0.10
CMBF1608H-181PCK	180 ± 25%	100	2000	0.10
CMBF1608H-221PCK	220 ± 25%	100	2000	0.10
CMBF1608H-301PCK	300 ± 25%	100	2000	0.10
CMBF1608H-471PCK	470 ± 25%	100	1000	0.20
CMBF1608H-601PCK	600 ± 25%	100	1000	0.20
CMBF1608H-102PCK	1000 ± 25%	100	1000	0.20

CMBF2012H Electrical Characteristics

Part Number	Impedance (Ω) ①	Test Frequency (MHz)	Rated current max. (mA)	DCR max. (Ω)
CMBF2012H-300PCK	30 ± 25%	100	6000	0.01
CMBF2012H-500PCK	50 ± 25%	100	3000	0.04
CMBF2012H-700PCK	70 ± 25%	100	3000	0.04
CMBF2012H-800PCK	80 ± 25%	100	3000	0.04
CMBF2012H-121PCK	120 ± 25%	100	3000	0.04
CMBF2012H-151PCK	150 ± 25%	100	2000	0.10
CMBF2012H-221PCK	220 ± 25%	100	2000	0.10
CMBF2012H-301PCK	300 ± 25%	100	1000	0.20
CMBF2012H-471PCK	470 ± 25%	100	1000	0.20
CMBF2012H-601PCK	600 ± 25%	100	1000	0.20

CMBF3216H Electrical Characteristics

Part Number	Impedance (Ω) ①	Test Frequency (MHz)	Rated current max. (mA)	DCR max. (Ω)
CMBF3216H-300PCK	30 ± 25%	100	3000	0.04
CMBF3216H-310PCK	31 ± 25%	100	6000	0.01
CMBF3216H-400PCK	40 ± 25%	100	4000	0.03
CMBF3216H-420PCK	42 ± 25%	100	4000	0.03
CMBF3216H-500PCK	50 ± 25%	100	6000	0.01
CMBF3216H-560PCK	56 ± 25%	100	4000	0.03
CMBF3216H-800PCK	80 ± 25%	100	3000	0.04
CMBF3216H-121PCK	120 ± 25%	100	2000	0.10
CMBF3216H-151PCK	150 ± 25%	100	2000	0.10
CMBF3216H-301PCK	300 ± 25%	100	2000	0.10
CMBF3216H-471PCK	470 ± 25%	100	1000	0.20
CMBF3216H-501PCK	500 ± 25%	100	3000	0.04
CMBF3216H-601PCK	600 ± 25%	100	2000	0.10

① Test equipment: E4991A or equivalent; Test Fixture: 16192A or equivalents; Test temperature: 25±10°C