

承认书

Specification

客户名称:

Customer Name: \_\_\_\_\_  
 (请填写贵司全名)

规格书编号:

Spicification NO : \_\_\_\_\_ Spec-CWLF-P Series Rev.01

客户品名 :

Product P/N : \_\_\_\_\_  
 (请填写贵司物料品名)

华拓品名 :

Manufacturer's P/N : \_\_\_\_\_  
 (请填写欲承认的华拓品名)

变更履历:

Revised record:

Rev.	Date	Changed Contents	Change reasons	Approved by
01	2013-12-10	New released		Buck

客户承认栏 (请签名并写明日期后回传)

广州华拓电子科技有限公司

Customer's Approval

Confirmed	Checked	Prepared
Buck	Dana	Amy

Type: CWLF2520P, 3225P, 4532P

Feature/特长

- Ferrite core wire wound type with plastic molding.
- Excellent solderability and heat resistance.
- High Q characteristics, high self-resonant frequency and high reliability.
- RoHS compliant.
- 绕线片式铁氧体塑封电感。
- 良好的可焊性、耐热性。
- 高可靠性。
- RoHS指定对应。

Application/用途

For high frequency applications such as mobile phones, high frequency modules (PA, VCO, FEM etc.), Bluetooth, W-LAN, UWB and tuners.

携帯電話、高周波数制品(PA, VCO, FEM etc.), Bluetooth, W-LAN, UWB 及无线电收音机適用。

Dimensions/外形图

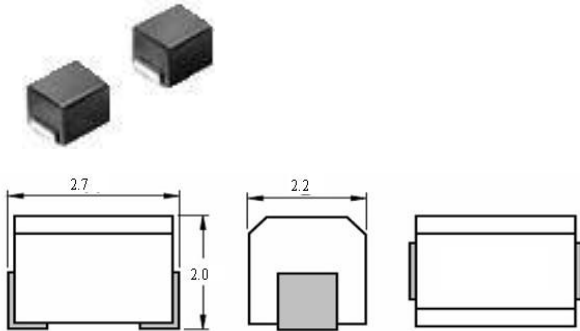

Recommended Land Pattern

推荐贴装尺寸

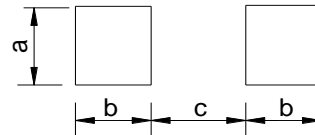

Unit: mm

Type	L	W	H	D(焊盘)	a	b	c	Packaging (pcs/reel)
CWLF252018P	2.5±0.2	2.0±0.2	1.8±0.2	1.4±0.1	1.5	1.0	1.5	2000
CWLF322522P	3.2±0.2	2.5±0.2	2.2±0.2	1.9±0.1	2.0	1.2	2.0	2000
CWLF453232P	4.5±0.3	3.2±0.2	3.2±0.2	2.6±0.1	2.8	1.5	3.0	1000
CWLF565050P	5.6±0.3	5.0±0.3	5.0±0.3	4.0±0.2	4.5	2.0	4.0	500

Dimensions without tolerance are typical./无公差尺寸为参考值。

Product Identification/品名注释

C W L F 252018 P - 47N J C

(1) (2) (3) (4) (5) (6) (7) (8) (9)

(1) SMD/表面安装制品

(2) Wire Wound Chip/绕线片式

(3) Inductors/电感

(4) Ferrite/铁氧体

(5) Dimension symbol/尺寸表示:

252018=2.5 X 2.0 X 1.8mm (L X W X H)

(6) Plastic Molding/塑胶封装

(7) Inductance value/电感值:

47N=47nH, R47=0.47uH, 4R7=4.7uH, 100=10uH

(8) Tolerance/公差:

J=±5%, K=±10%

(9) Packing Style/包装形态:C=Carrier taping/载带包装

### CWLF252018P Electrical Characteristics

Part Number	Inductance (uH)	Inductance tolerance	Test frequency L/Q(MHz)	Q min.	DCR max. (Ω)	Rated current (mA)	SRF(MHz) min.
CWLF252018P-10N□C	0.010	J,K	100	15	0.26	530	2150
CWLF252018P-12N□C	0.012	J,K	100	15	0.27	500	2050
CWLF252018P-15N□C	0.015	J,K	100	15	0.29	480	2000
CWLF252018P-18N□C	0.018	J,K	100	15	0.31	450	1850
CWLF252018P-22N□C	0.022	J,K	100	15	0.37	420	1650
CWLF252018P-27N□C	0.027	J,K	100	15	0.40	410	1550
CWLF252018P-33N□C	0.033	J,K	100	20	0.42	400	1450
CWLF252018P-39N□C	0.039	J,K	100	20	0.45	380	1350
CWLF252018P-47N□C	0.047	J,K	100	20	0.50	360	1200
CWLF252018P-56N□C	0.056	J,K	100	20	0.60	340	1100
CWLF252018P-68N□C	0.068	J,K	100	20	0.65	320	1050
CWLF252018P-82N□C	0.082	J,K	100	20	0.75	300	900
CWLF252018P-R10□C	0.10	J,K	100	20	0.80	280	800
CWLF252018P-R12□C	0.12	J,K	25.2	30	0.30	550	700
CWLF252018P-R15□C	0.15	J,K	25.2	30	0.35	500	550
CWLF252018P-R18□C	0.18	J,K	25.2	30	0.40	460	500
CWLF252018P-R22□C	0.22	J,K	25.2	30	0.50	430	450
CWLF252018P-R27□C	0.27	J,K	25.2	30	0.55	420	425
CWLF252018P-R33□C	0.33	J,K	25.2	30	0.60	400	400
CWLF252018P-R39□C	0.39	J,K	25.2	30	0.65	375	375
CWLF252018P-R47□C	0.47	J,K	25.2	30	0.68	350	350
CWLF252018PR56□C	0.56	J,K	25.2	30	0.75	325	325
CWLF252018P-R68□C	0.68	J,K	25.2	30	0.85	300	300
CWLF252018P-R82□C	0.82	J,K	25.2	30	1.00	260	260
CWLF252018P-1R0□C	1.0	J,K	7.96	30	1.10	245	245
CWLF252018P-1R2□C	1.2	J,K	7.96	30	1.20	230	230
CWLF252018P-1R5□C	1.5	J,K	7.96	30	1.30	220	182
CWLF252018P-1R8□C	1.8	J,K	7.96	30	1.45	210	135
CWLF252018P-2R2□C	2.2	J,K	7.96	30	1.55	200	105
CWLF252018P-2R7□C	2.7	J,K	7.96	30	1.70	195	70
CWLF252018P-3R3□C	3.3	J,K	7.96	30	1.90	185	55
CWLF252018P-3R9□C	3.9	J,K	7.96	30	2.10	180	48
CWLF252018P-4R7□C	4.7	J,K	7.96	30	2.30	175	43
CWLF252018P-5R6□C	5.6	J,K	7.96	25	2.50	170	42
CWLF252018P-6R8□C	6.8	J,K	7.96	25	2.70	165	39
CWLF252018P-8R2□C	8.2	J,K	7.96	25	3.05	160	36
CWLF252018P-100□C	10	J,K	2.52	25	3.50	155	33
CWLF252018P-120□C	12	J,K	2.52	25	3.80	150	30
CWLF252018P-150□C	15	J,K	2.52	25	4.40	140	26
CWLF252018P-180□C	18	J,K	2.52	25	4.80	130	24
CWLF252018P-220□C	22	J,K	2.52	25	5.50	125	22
CWLF252018P-270□C	27	J,K	2.52	25	6.30	115	21
CWLF252018P-330□C	33	J,K	2.52	25	7.10	110	20
CWLF252018P-390□C	39	J,K	2.52	20	9.50	90	18
CWLF252018P-470□C	47	J,K	2.52	20	11.1	80	17
CWLF252018P-560□C	56	J,K	2.52	20	12.1	75	16
CWLF252018P-680□C	68	J,K	2.52	20	16.6	70	15
CWLF252018P-820□C	82	J,K	2.52	20	19.0	66	13
CWLF252018P-101□C	100	J,K	0.796	15	21.0	60	12

□ Tolerance: J=±5%, K=±10%

• Test equipments:

Inductance Q : HP4291A+16193A, or equivalent; SRF: HP8720C, or equivalent; DCR: YOKOGAWA TYPE7561, or equivalent

• Rated current : is the current at which the temperature rise is 20°C.

### CWLF322522P Electrical Characteristics

Part Number	Inductance (uH)	Inductance tolerance	Test frequency L/Q(MHz)	Q min.	DCR max. (Ω)	Rated current (mA)	SRF(MHz) min.
CWLF322522P-10N□C	0.010	J,K	100	15	0.13	450	2500
CWLF322522P-12N□C	0.012	J,K	100	17	0.14	450	2300
CWLF322522P-15N□C	0.015	J,K	100	19	0.16	450	2100
CWLF322522P-18N□C	0.018	J,K	100	21	0.18	450	1900
CWLF322522P-22N□C	0.022	J,K	100	23	0.20	450	1700
CWLF322522P-27N□C	0.027	J,K	100	23	0.22	450	1500
CWLF322522P-33N□C	0.033	J,K	100	25	0.24	450	1400
CWLF322522P-39N□C	0.039	J,K	100	25	0.27	450	1300
CWLF322522P-47N□C	0.047	J,K	100	26	0.30	450	1200
CWLF322522P-56N□C	0.056	J,K	100	26	0.33	450	1100
CWLF322522P-68N□C	0.068	J,K	100	27	0.36	450	1000
CWLF322522P-82N□C	0.082	J,K	100	27	0.40	450	900
CWLF322522P-R10□C	0.10	J,K	100	28	0.44	450	700
CWLF322522P-R12□C	0.12	J,K	25.2	30	0.22	450	500
CWLF322522P-R15□C	0.15	J,K	25.2	30	0.25	450	450
CWLF322522P-R18□C	0.18	J,K	25.2	30	0.28	450	400
CWLF322522P-R22□C	0.22	J,K	25.2	30	0.32	450	350
CWLF322522P-R27□C	0.27	J,K	25.2	30	0.36	450	320
CWLF322522P-R33□C	0.33	J,K	25.2	30	0.40	450	300
CWLF322522P-R39□C	0.39	J,K	25.2	30	0.45	450	250
CWLF322522P-R47□C	0.47	J,K	25.2	30	0.50	450	220
CWLF322522P-R56□C	0.56	J,K	25.2	30	0.55	450	180
CWLF322522P-R68□C	0.68	J,K	25.2	30	0.60	450	160
CWLF322522P-R82□C	0.82	J,K	25.2	30	0.65	450	140
CWLF322522P-1R0□C	1.0	J,K	7.96	30	0.70	400	120
CWLF322522P-1R2□C	1.2	J,K	7.96	30	0.75	390	100
CWLF322522P-1R5□C	1.5	J,K	7.96	30	0.85	370	85
CWLF322522P-1R8□C	1.8	J,K	7.96	30	0.90	350	80
CWLF322522P-2R2□C	2.2	J,K	7.96	30	1.00	320	75
CWLF322522P-2R7□C	2.7	J,K	7.96	30	1.10	290	70
CWLF322522P-3R3□C	3.3	J,K	7.96	30	1.20	260	60
CWLF322522P-3R9□C	3.9	J,K	7.96	30	1.30	250	55
CWLF322522P-4R7□C	4.7	J,K	7.96	30	1.50	220	50
CWLF322522P-5R6□C	5.6	J,K	7.96	30	1.60	200	45
CWLF322522P-6R8□C	6.8	J,K	7.96	30	1.80	180	40
CWLF322522P-8R2□C	8.2	J,K	7.96	30	2.00	170	35
CWLF322522P-10□C	10	J,K	2.52	30	2.10	150	30
CWLF322522P-12□C	12	J,K	2.52	30	2.50	140	20
CWLF322522P-15□C	15	J,K	2.52	30	2.80	130	20
CWLF322522P-18□C	18	J,K	2.52	30	3.30	120	20
CWLF322522P-22□C	22	J,K	2.52	30	3.70	110	20
CWLF322522P-27□C	27	J,K	2.52	30	5.00	80	20
CWLF322522P-33□C	33	J,K	2.52	30	5.60	70	17
CWLF322522P-39□C	39	J,K	2.52	30	6.40	65	16
CWLF322522P-47□C	47	J,K	2.52	30	7.00	60	15
CWLF322522P-56□C	56	J,K	2.52	30	8.00	55	13
CWLF322522P-68□C	68	J,K	2.52	30	9.00	50	12
CWLF322522P-82□C	82	J,K	2.52	30	10.0	45	11
CWLF322522P-101□C	100	J,K	0.796	20	10.0	40	10
CWLF322522P-121□C	120	J,K	0.796	20	11	70	10
CWLF322522P-151□C	150	J,K	0.796	20	15	65	8
CWLF322522P-181□C	180	J,K	0.796	20	17	60	7
CWLF322522P-221□C	220	J,K	0.796	20	21	50	7
CWLF322522P-271□C	270	J,K	0.796	20	28	45	6
CWLF322522P-331□C	330	J,K	0.796	20	34	40	5
CWLF322522P-391□C	390	J,K	0.796	20	36	35	5
CWLF322522P-471□C	470	J,K	0.796	20	40	25	4

□ Tolerance: J=±5%, K=±10%.

• Test equipments: Inductance Q : HP4291A+16193A, or equivalent; SRF: HP8720C, or equivalent; DCR: YOKOGAWA TYPE7561, or equivalent

• Rated current : is the current at which the temperature rise is 20°C.

### CWLF453232P Electrical Characteristics

Part Number	Inductance (uH)	Inductance tolerance	Test frequency L/Q(MHz)	Q min.	DCR max. (Ω)	Rated current (mA)	SRF(MHz) min.
CWLF453232P-1R0□C	1.0	J,K	7.96	50	0.5	450	100
CWLF453232P-1R2□C	1.2	J,K	7.96	50	0.55	430	80
CWLF453232P-1R5□C	1.5	J,K	7.96	50	0.6	410	70
CWLF453232P-1R8□C	1.8	J,K	7.96	50	0.65	390	60
CWLF453232P-2R2□C	2.2	J,K	7.96	50	0.7	380	55
CWLF453232P-2R7□C	2.7	J,K	7.96	50	0.75	370	50
CWLF453232P-3R3□C	3.3	J,K	7.96	50	0.8	355	45
CWLF453232P-3R9□C	3.9	J,K	7.96	50	0.9	330	40
CWLF453232P-4R7□C	4.7	J,K	7.96	50	1	315	35
CWLF453232P-5R6□C	5.6	J,K	7.96	50	1.1	300	33
CWLF453232P-6R8□C	6.8	J,K	7.96	50	1.2	285	27
CWLF453232P-8R2□C	8.2	J,K	7.96	50	1.4	270	25
CWLF453232P-100□C	10	J,K	2.52	50	1.6	250	20
CWLF453232P-120□C	12	J,K	2.52	50	2	225	18
CWLF453232P-150□C	15	J,K	2.52	50	2.5	200	17
CWLF453232P-180□C	18	J,K	2.52	50	2.8	190	15
CWLF453232P-220□C	22	J,K	2.52	50	3.2	180	13
CWLF453232P-270□C	27	J,K	2.52	50	3.6	170	12
CWLF453232P-330□C	33	J,K	2.52	50	4.0	160	11
CWLF453232P-390□C	39	J,K	2.52	50	4.5	150	10
CWLF453232P-470□C	47	J,K	2.52	50	5	140	10
CWLF453232P-560□C	56	J,K	2.52	50	5.5	135	9
CWLF453232P-680□C	68	J,K	2.52	50	6	130	9
CWLF453232P-820□C	82	J,K	2.52	50	7	120	8
CWLF453232P-101□C	100	J,K	0.796	40	8	110	8
CWLF453232P-121□C	120	J,K	0.796	40	8	110	6
CWLF453232P-151□C	150	J,K	0.796	40	9	105	5
CWLF453232P-181□C	180	J,K	0.796	40	9.5	102	5
CWLF453232P-221□C	220	J,K	0.796	40	10	100	4
CWLF453232P-271□C	270	J,K	0.796	40	12	92	4
CWLF453232P-331□C	330	J,K	0.796	40	14	85	3.5
CWLF453232P-391□C	390	J,K	0.796	40	16	80	3
CWLF453232P-471□C	470	J,K	0.796	40	26	62	3
CWLF453232P-561□C	560	J,K	0.796	30	30	50	3
CWLF453232P-681□C	680	J,K	0.796	30	30	50	3
CWLF453232P-821□C	820	J,K	0.796	30	35	30	2.5
CWLF453232P-102□C	1000	J,K	0.252	30	40	30	2.5

### CWLF565050P Electrical Characteristics

Part Number	Inductance (uH)	Inductance tolerance	Test frequency L/Q(MHz)	Q min.	DCR max. (Ω)	Rated current (mA)	SRF(MHz) min.
CWLF565050P-1R2□C	1.2	J,K	0.252	30	17	75	1.5
CWLF565050P-1R5□C	1.5	J,K	0.252	30	20	70	1.4
CWLF565050P-1R8□C	1.8	J,K	0.252	30	30	60	1.3
CWLF565050P-2R2□C	2.2	J,K	0.252	30	35	55	1.2
CWLF565050P-2R7□C	2.7	J,K	0.252	30	55	45	1.1
CWLF565050P-3R3□C	3.3	J,K	0.252	30	60	40	1
CWLF565050P-3R9□C	3.9	J,K	0.252	30	70	38	1
CWLF565050P-4R7□C	4.7	J,K	0.252	30	78	36	0.9
CWLF565050P-5R6□C	5.6	J,K	0.252	30	85	33	0.8
CWLF565050P-6R8□C	6.8	J,K	0.252	30	110	30	0.7
CWLF565050P-8R2□C	8.2	J,K	0.252	30	125	28	0.6
CWLF565050P-100□C	10	J,K	0.0796	20	150	25	0.5

□ Tolerance: J=±5%, K=±10%.

• Test equipments:

Inductance Q : HP4291A+16193A, or equivalent; SRF: HP8720C, or equivalent; DCR: YOKOGAWA TYPE7561, or equivalent

• Rated current : is the current at which the temperature rise is 20°C.